

LONGITUDINAL SECTION - SW LINE A
HORZ 1:250 VERT 1:50

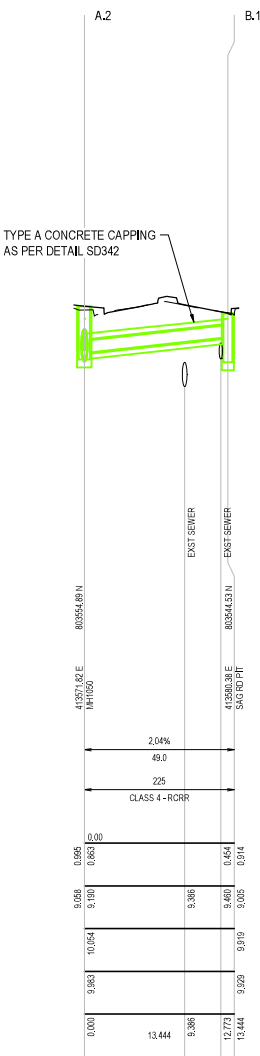

LONGITUDINAL SECTION - SW LINE B
HORZ 1:250 VERT 1:50

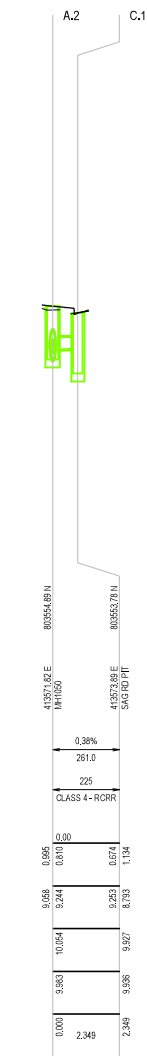

LONGITUDINAL SECTION - SW LINE C
HORZ 1:250 VERT 1:50

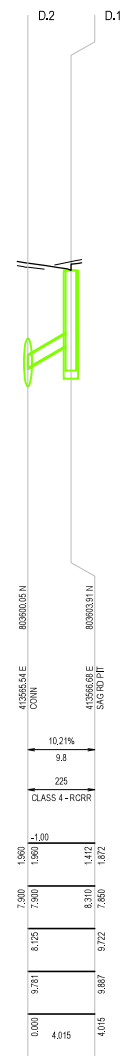

LONGITUDINAL SECTION - SW LINE D
HORZ 1:250 VERT 1:50

Rev	Description	Checked	Approved	Date
2	REISSUED FOR CONSTRUCTION	KMP	DM*	11.07.24
1	ISSUED FOR CONSTRUCTION	SN*	DM*	28.03.24
0	ISSUED FOR TENDER	SN*	DM*	08.12.23

Author	N. MACQUE	Drafting Check	G. DOUGHERTY*
Designer	D. BREWITT	Design Check	J. KINNESS*

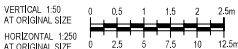

GHD
Level 1, 207 Queen Street East
Hastings, 4122, New Zealand
Tel: 06 853 9280
www.ghd.com

GHD Limited
Conditions of Use: This document may only be used by GHD's client and any other person who GHD has agreed can use this document for the purpose for which it was prepared and must not be used by any other person or for any other purpose.



Project No.
12574435

Client: HASTINGS DISTRICT COUNCIL
Project: HPSC NOTTINGLEY / LYNDHURST ROUNDABOUT
Status: CONSTRUCTION

Drawing Title: STORMWATER LONGITUDINAL SECTIONS
Sheet: 1

Drawing No.
12574435-W402

Size: A1
Rev: 2

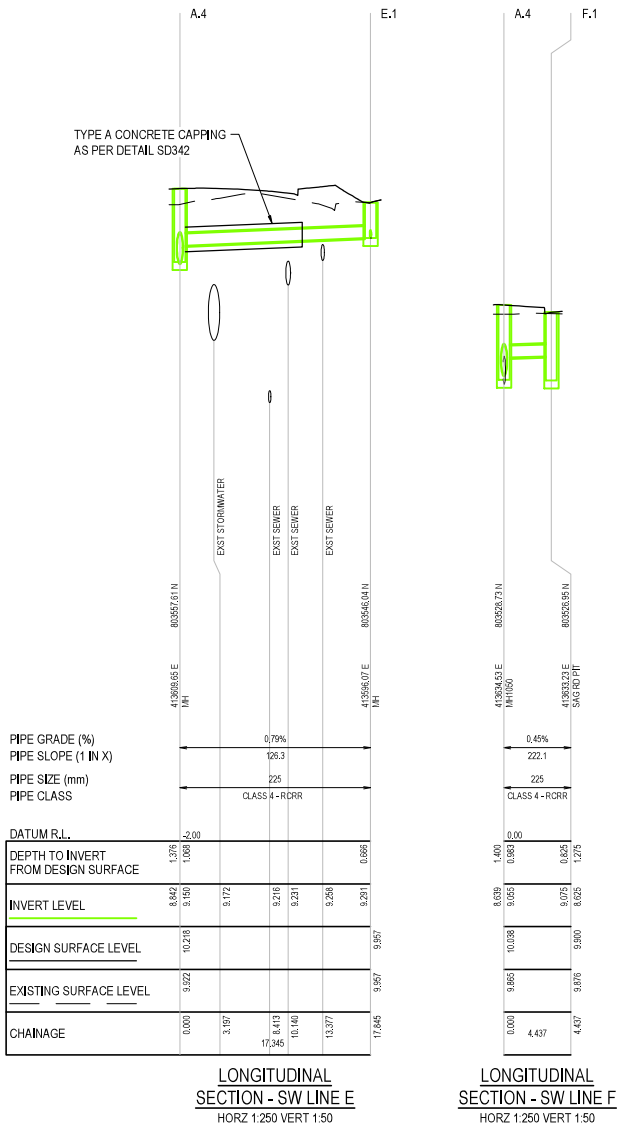

Rev	Description	Checked	Approved	Date
2	REISSUED FOR CONSTRUCTION	KMP	DM*	11.07.24
1	ISSUED FOR CONSTRUCTION	SN*	DM*	28.03.24
0	ISSUED FOR TENDER	SN*	DM*	08.12.23

Author	N. MACQUE	Drafting Check	G. DOUGHERTY*
Designer	D. BREWITT	Design Check	J. KINROSS*

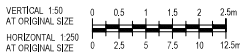

Level 1, 207 Queen Street East
Hastings, 4122, New Zealand
T +64 6 833 8080
W www.ghd.com

GHD Limited
Conditions of Use: This document may only be used by GHD's client and any other person who GHD has agreed can use this document for the purpose for which it was prepared and must not be used by any other person or for any other purpose.



Client	HASTINGS DISTRICT COUNCIL
Project	HPSC NOTTINGLEY / LYNDHURST ROUNDABOUT
Project No.	12574435
Status	CONSTRUCTION

Drawing Title: STORMWATER LONGITUDINAL SECTIONS SHEET 2

Drawing No. 12574435-W403

Size A1
Rev 2

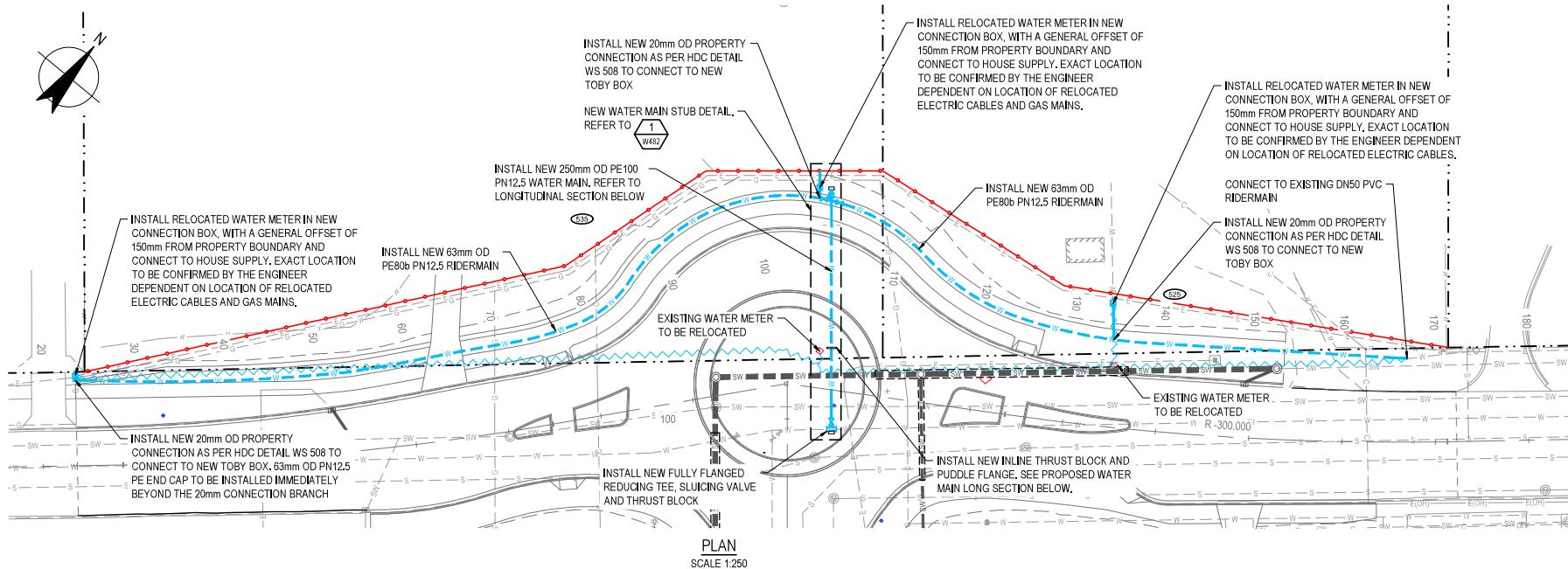

LEGEND - PROPOSED	
	DESIGNATION BOUNDARY
	CONTROL ALIGNMENT AND CHAINAGE
	NEW KERB AND CHANNEL
	WATER MAIN
	EXISTING WATER SUPPLY FOR REMOVAL
	STORMWATER
LEGEND - EXISTING	
	LEGAL BOUNDARY
LEGEND - EXISTING SERVICES	
	SEWER PIPE
	STORMWATER PIPE
	WATER
	GAS
	UNDERGROUND POWER
	OVERHEAD POWER LINES
	CHORUS CABLE

- NOTES:
- REFER TO DRG 12574435-G003 FOR GENERAL CONSTRUCTION AND THREE WATERS NOTES.
 - LONG SECTION IS INDICATIVE ONLY AND WILL BE DEPENDENT UPON FITTING SPACINGS.
 - RIDERMAIN TO BE OFFSET 600mm FROM THE EDGE OF THE PROPOSED PATH.

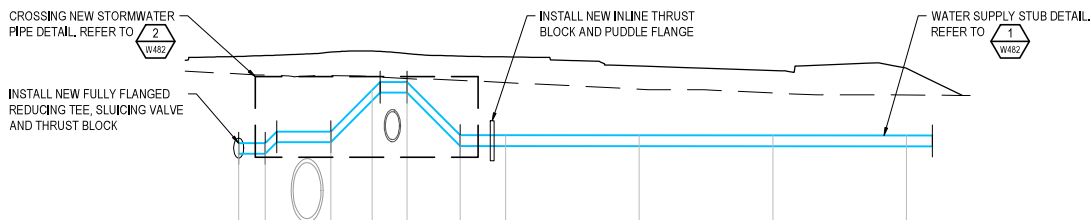

DATUM RL 6.00										
DESIGN SURFACE LEVEL	10.43	10.44	10.51	10.53	10.48	10.43	10.25	10.16	10.21	
LEVEL DIFFERENCE TO PIPE OBVERT	-1.62	-1.64	-1.49	-0.73	-0.53	-1.48	-1.30	-1.22	-1.26	
DESIGN OBVERT LEVEL	8.80	8.80	9.02	9.80	9.95	8.95	8.95	8.95	8.94	
EXISTING SURFACE LEVEL	10.10	10.08	10.07	10.05	10.01	9.98	9.91	9.74	9.71	
CHAINAGE	0.00	3.00	3.45	5.00	6.30	8.30	10.00	15.00	20.00	25.00

LONGITUDINAL SECTION - PROPOSED WATER MAIN
HORZ 1:100 VERT 1:50

Rev	Description	Checked	Approved	Date
3	REISSUED FOR CONSTRUCTION	KMP	DM*	11.07.24
2	PROPOSED WATER PIPE UPDATED	KMP	DM*	24.05.24
1	ISSUED FOR CONSTRUCTION	SN*	DM*	28.03.24
0	ISSUED FOR TENDER	SN*	DM*	08.12.23
Author	N. MACHÉ	Drafting Check	G. DOUGHERTY*	
Designer	D. MCKEOWN	Design Check	J. KINNEDY*	

Plot Date: 9 July 2024 - 2:39 PM

Plotted by: Ray Emmanuel Geronimo

File Name: C:\12574435\W482\12574435-12574435 - Not Lynd RBL_3157\CADD\Drawings\12574435-W481_W484.dwg

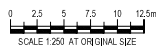

HERETAUNGA
HASTINGS DISTRICT COUNCIL



GHD Limited
Consent of use: This document may only be used by GHD's client and any other person who GHD has agreed can use this document for the purpose for which it was prepared and must not be used by any other person or for any other purpose.



Project No.
12574435

Client
HASTINGS DISTRICT COUNCIL
Project
HPSC NOTTINGLEY / LYNDHURST
ROUNDAABOUT
Status
CONSTRUCTION

Drawing Title
WATER SUPPLY LAYOUT PLAN
AND LONGITUDINAL SECTION

Drawing No.
12574435-W481

Size
A1

Rev
3



EXISTING DN375
CLS WATER MAIN

DN200 DI SLUICE VALVE

INSTALL 150x1000 INLINE
THRUST BLOCK TO HDC
WS 507

PUDDLE FLANGE

FLANGE ADAPTOR
FLANGE

DN50 GATE VALVE
250mm OD PN12.5
PE100 WATER MAIN

INSTALL DN200 FIRE HYDRANT

BLANK FLANGE

1.0m MIN.

INSTALL 300x600 THRUST
BLOCK TO HDC WS 507

INSTALL 300x600
THRUST BLOCK TO
HDC WS 507

EXISTING DN375
CLS WATER MAIN

INSTALL DN375 - DN200 DI FULLY
FLANGED REDUCING TEE

REFER TO DETAIL

INSTALL 1.2m DN200 DI
FLANGED SPOOL PIECE

INSTALL DN250 TAPPING SADDLE
AND CONNECT TO 63mm OD
PN12.5 PE80b RIDER MAIN

DN50 GATE VALVE

1 WATER SUPPLY STUB DETAIL
SCALE 1:10

INSTALL DN200 DI FLANGED
SPOOL PIECE (LENGTH TO
BE DETERMINED ON SITE)

INSTALL DN200 DI
FLANGED 45° BEND

INSTALL DN200 DI
FLANGED 45° BEND

INSTALL DN200 DI FLANGED
SPOOL PIECE (LENGTH TO
BE DETERMINED ON SITE)

INSTALL DN200 DI FLANGED 45° BEND.
BENDS OPTIONAL DEPENDING ON
LEVEL OF EXISTING DN1050
STORMWATER PIPE AND EXISTING
DN375 WATER MAIN

DN200 DI FLANGED
SPOOL PIECE

PROPOSED DN525
STORMWATER PIPE

EXISTING DN1050
STORMWATER PIPE

2 CROSSING NEW STORMWATER PIPE DETAIL
SCALE 1:10

LEGEND - PROPOSED

DESIGNATION BOUNDARY

LEGEND - REALIGNED SERVICES

GAS

UNDERGROUND POWER

Rev	Description	Checked	Approved	Date
3	REISSUED FOR CONSTRUCTION	KMP	DM*	11.07.24
2	PROPOSED WATER PIPE UPDATED	KMP	DM*	24.05.24
1	ISSUED FOR CONSTRUCTION	SN*	DM*	28.03.24
0	ISSUED FOR TENDER	SN*	DM*	08.12.23
Author	N. MACOE	Drafting Check	G. DOUGHERTY*	
Designer	D. MCKEOWN	Design Check	J. KINNESS*	

0 0.1 0.2 0.3 0.4 0.5m
SCALE 1:10 AT ORIGINAL SIZE

HERETAUNGA
HASTINGS DISTRICT COUNCIL



GHD Limited
Conditions of Use: This document may only be used by GHD's client and any other person who GHD has agreed can use this document for the purpose for which it was prepared and must not be used by any other person or for any other purpose.



Project No.
12574435

Client
HASTINGS DISTRICT COUNCIL

Project
HPSC NOTTINGLEY / LYNDHURST
ROUNDBOUT

Status
CONSTRUCTION

Drawing Title
WATER SUPPLY STUB DETAIL

Drawing No.
12574435-W482

Size
A1

Rev
3